

C2X - Installation Instructions -

IMPORTANT: Please read carefully the following instructions before beginning.

 <p>OLD WORK Locate and remove the four screws that secure the tunnels. Remove tunnels. Unscrew the four screws at the bottom of the box to remove the leveling feet.</p>	<p>1</p>  <p>Determine box location and position in accordance to floor plans. Adjust the leveling screws until the desired level is met.</p>	<p>2</p>  <p>Attach conduits to the selected knockouts. Install temporary cover to prevent debris from entering the box during concrete pour. Duct tape all edges and any cracks or seams where concrete may enter.</p>	<p>3</p>  <p>Fix and secure box to the floor using concrete mix. Add concrete mixture below and around box (if necessary) to level the box in accordance to the final floor level desired.</p>
<p>4</p>  <p>Hand toweling near box edges is suggested once concrete has been poured.</p>	<p>5</p>  <p>Once Concrete has cured, remove temporary cover. Locate and pull wires. Two tunnels allow to feed the opposite wiring compartment (on the other side of the box)</p>	<p>Warning:</p> <p>To be installed and/or used in accordance with appropriate electrical codes and regulations.</p> <p>Warning:</p> <p>To avoid fire, electrical shock and/or electrocution turn power OFF at the circuit breaker before wiring.</p>	
<p>6</p>  <p>Detach mounting panel to access the wiring compartment and install the barrier on the appropriate location.</p>	 <p>Position and install the barrier based on the selected faceplates: (1) External - Apply to #23601 and #23612 (2) Internal - Apply to #44607 and #24633</p> <p>Enlarged view</p>		

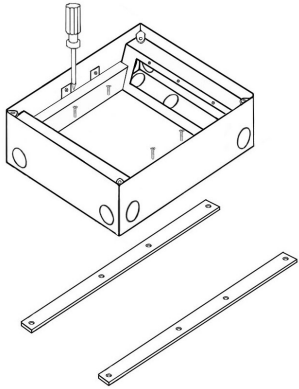
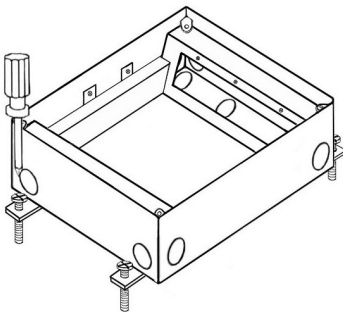
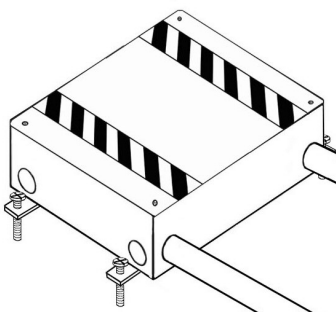
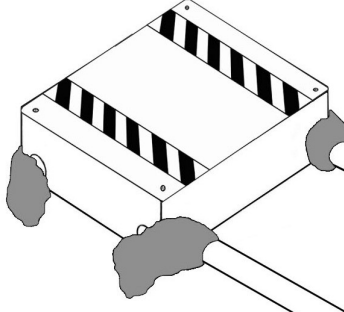
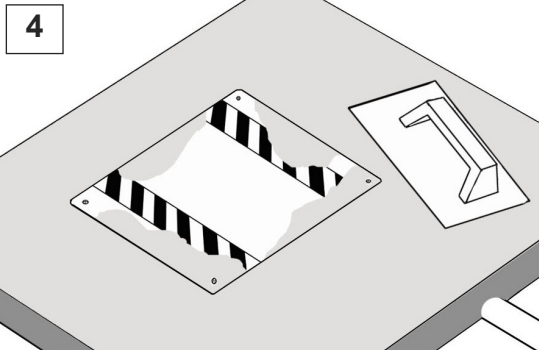
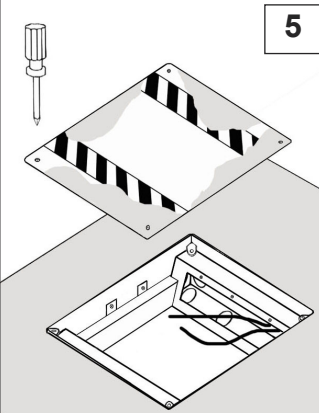
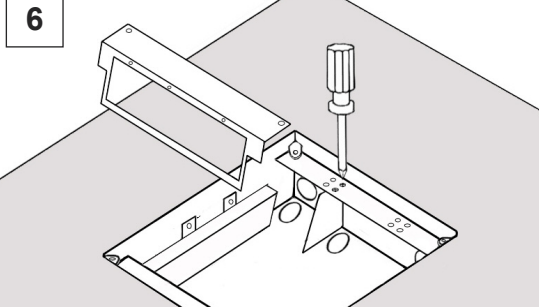
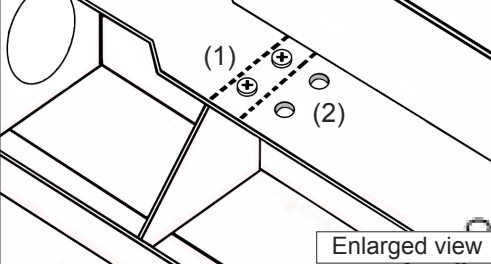

Caution:

Wire devices in accordance with the NEC.
If you are not sure about existing conductor wires, color coding, polarity and circuit feed contact a licensed electrician.



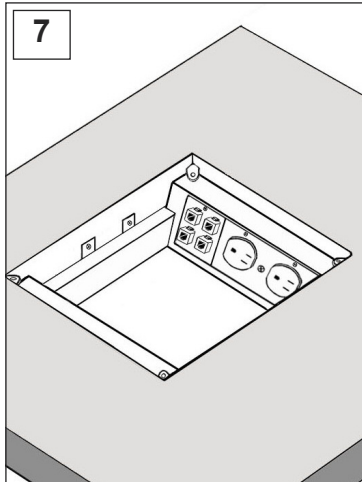

7

Wire devices in accordance with the NEC.
Attach faceplates to mounting panel.
Barriers must be installed when placing line and low voltage devices on the same side of the box.

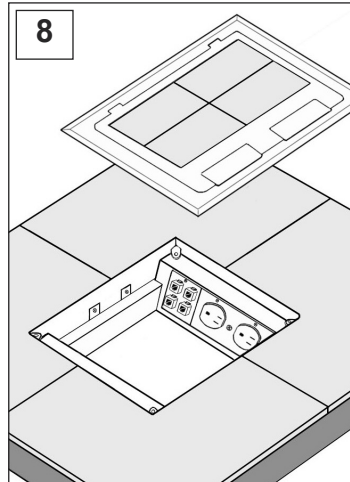

8

Install the desired floor covering material (terrazzo, tile, limestone, carpet, etc) on top of the lid -if applicable-
Recessed area: 7/16" (12 mm)

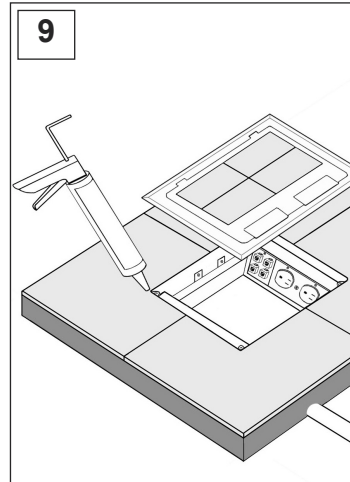

9

Before installing the cover, apply a generous amount of silicone caulk around the opening of the floor box (where the flange sits). Verify that all the perimeter has been properly sealed.

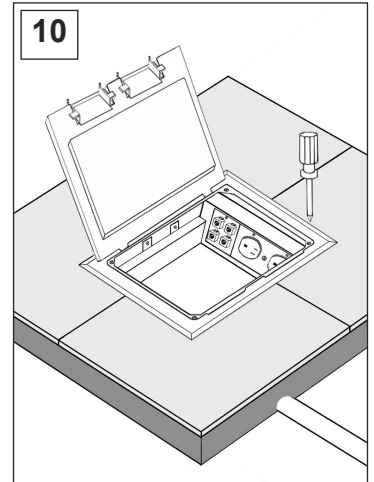

10

Secure the cover to the box using the four supplied screws.
Installation Complete.

Leveling the Box

Beveled cover

CORRECT

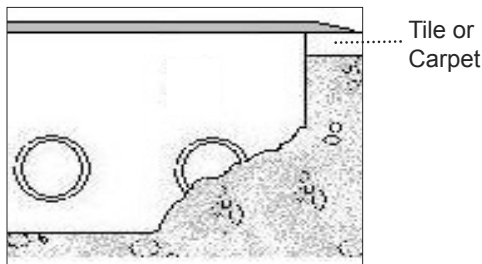

When a floor covering thickness is known in advance (tile, wood, carpet), estimating level to obtain a floor covering flushed with floor box is suggested (as shown on the figure above) However it is not completely necessary.

Non-Beveled Cover Installation

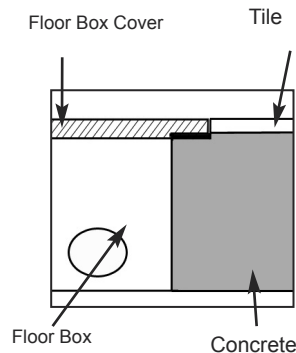

1) Depending on the thickness of the floor covering material, level the box as necessary to obtain a flush finish between the cover and the final floor level as shown on the illustration.

2) Before installing the cover, apply a generous amount of silicone caulk around the opening of the floor box. Verify that all the perimeter has been properly sealed.

3) Secure the cover to the box using the four supplied screws.

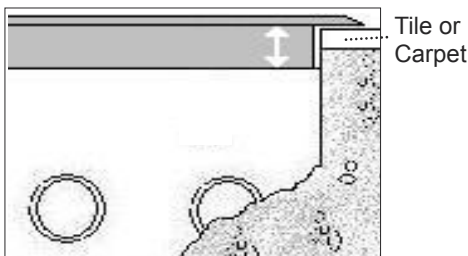

When concrete is over poured, the cover can still be applied. Need longer screws (supplied by others)

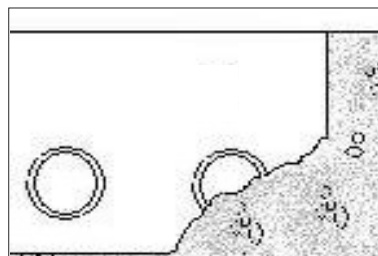

When concrete is flushed with box, the cover can be applied. Need longer screws (supplied by others)

INCORRECT

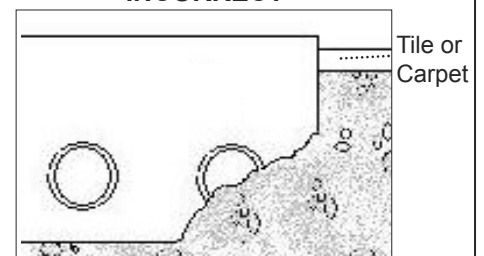

Avoid this situation