

# PF10266 Surface Mount Box -Installation Guide-

**IMPORTANT:** Please read carefully the following instructions before beginning.

Installation process varies depending on the method used to feed the box.

See the feeding options below (step 2, A, B, C) and select the appropriate method for your application.



**ELECTRICAL HAZARD!**  
**TURN POWER OFF BEFORE WORK!**

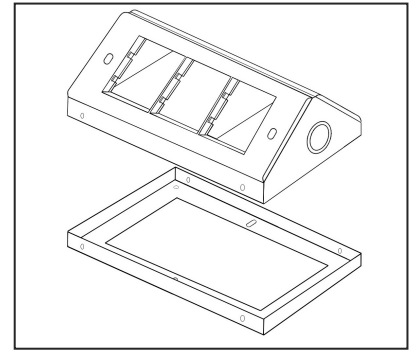
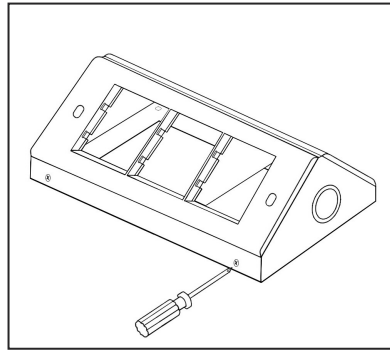

1

Remove the screws located on the front side of the box to separate the base from the body. Keep the screws in a safe place for later use.

## A: Installation when feeding the box with a conduit

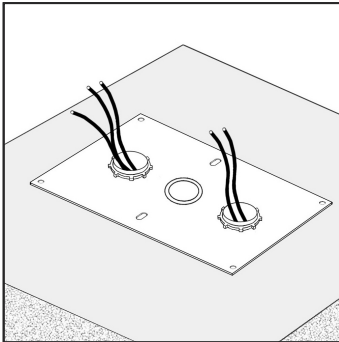

Attach a 1/2" or 3/4" conduit to the FBS133 Bottom plate with Knockouts (Sold Separate). The FBS133 plate has three concentric knockouts for 1/2" and 3/4" conduits.

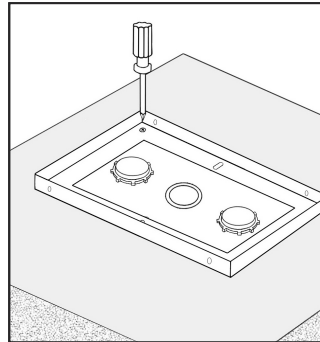

Align the base of the box with the KO plate. Using the appropriate screws, mount and secure them to the selected area

NOTE: The base and the KO bottom plate (#FBS133) have screw holes at all four corners.

Continue to step 3.

## B: Installation using a flush mounted outlet box

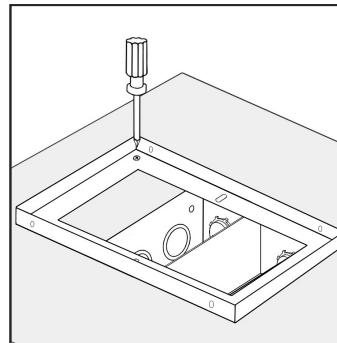
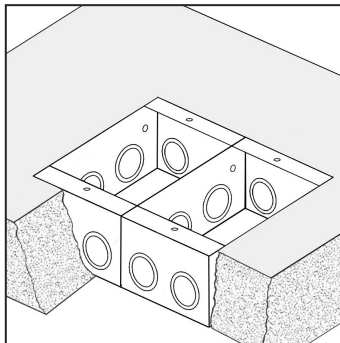
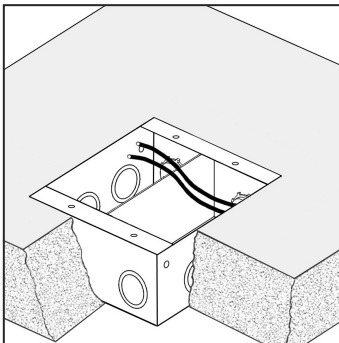

Install an "old work" type two gang outlet box or two one gang outlet boxes flush with the floor. Ensure that the service divider on the PF10266 matches the position of the divider on the two gang outlet box prior to securing the base of the PF10266 to the Outlet Box. See barrier positioning details and continue to step 3.

## C: Installation when feeding the box from a wood/raised floor opening

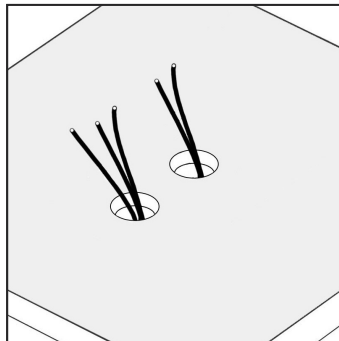

Drill the necessary holes on the wood/raised floor and pull the cables out thru the openings.

NOTE: Method recommended for A/V, VGA connectors and connectors larger than 3/4".

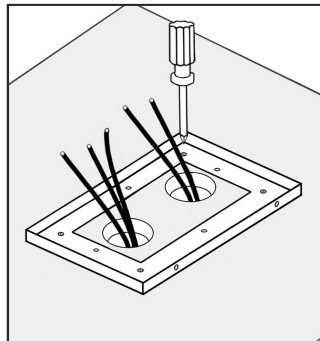

Secure the base of the PF10266 Surface Mounted Floor Box to the floor. The box base has screw holes at all four corners. Continue to step 3.

# PF10266 Surface Mount Box -Installation Guide-

## Barrier Positioning

When installing the mounting base on top of a **single gang outlet box**, place the barrier in the slot aligned with the side wall of the outlet box. The 1/3 compartment of the PF10266 box may be fed through the opening in the base. The 2/3 compartment (8 Modules) of the PF10266 box will be fed from the outlet box. (See Fig A)

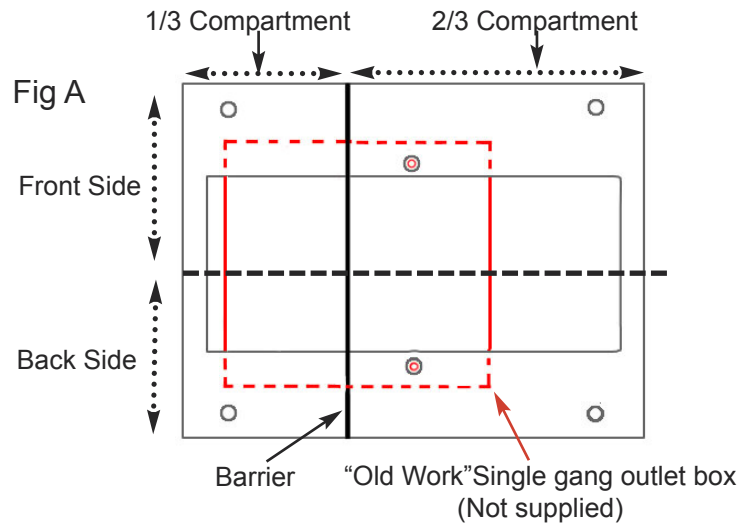

When conduits for both line and low voltage cables are required, an "Old Work type Two gang outlet box" with a barrier should be installed. The box should be flush with the surface. The barrier divides the outlet box in two compartments. Select and attach the conduits to the corresponding compartment. Position and mount the base box on top of the **Two gang outlet box** aligning the barrier of the PF10266 with the barrier of the outlet box. It will keep the compartments properly separated.

One compartment of the outlet box will feed the bigger compartment (8 Modules) of the PF10266, while the second compartment of the outlet box will feed the smaller compartment (4 Modules) of the PF10266 box. (See Fig B)

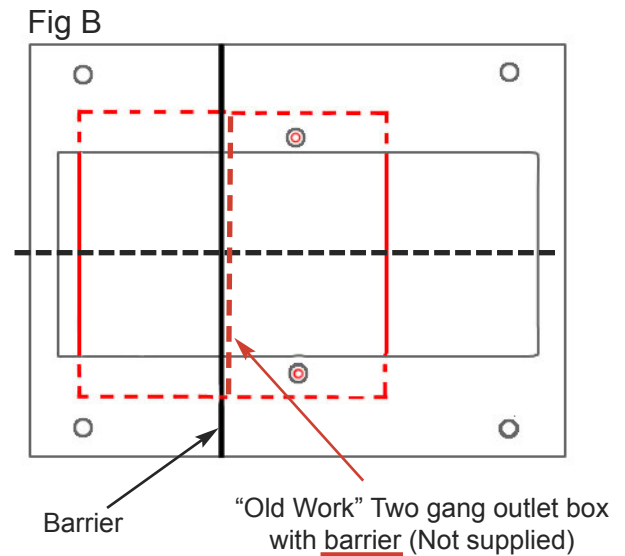

## KO adapter plate - Part # FBS133 (Order separately)

The FBS133 KO adapter plate has three concentric knockouts for 1/2" and 3/4" conduits. When a service divider is installed, the box is divided in two compartments (1/3 + 2/3). Two knockouts are positioned to feed the 2/3 (bigger) compartment and one knockout to feed the 1/3 (smaller) compartment.

- Select the knockouts for low and line voltage and attach the conduits accordingly.
- Position and align the base with the KO plate. The screw holes at all four corners must be aligned on both parts.
- Use screws (not supplied) to fasten the base and the KO plate to the mounting surface.

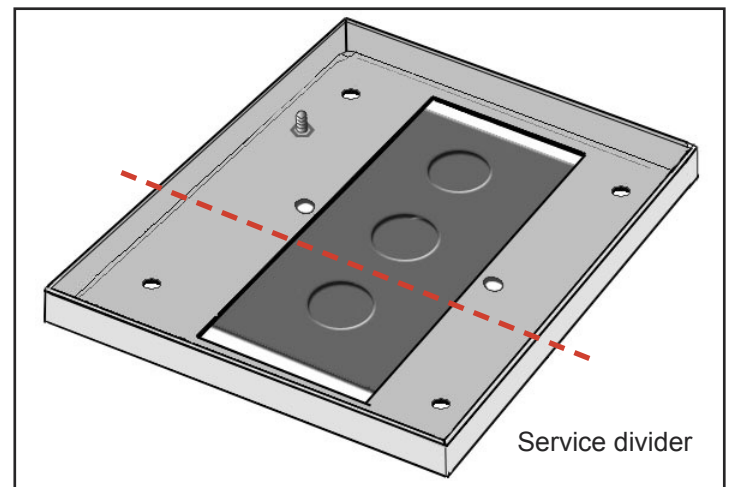

**PF10266**  
**Surface Mount Box**  
**-Installation Guide-**

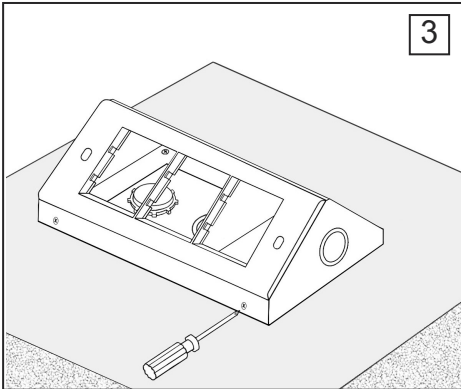

3

Fasten the screws removed on the step 1 to secure the body (box) to the base.

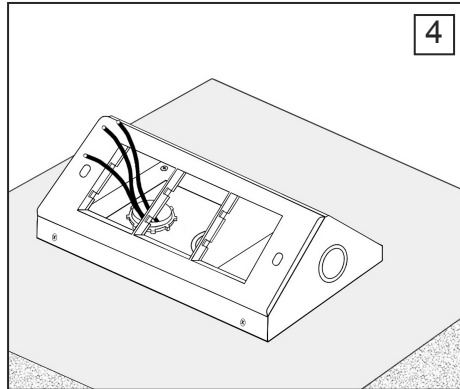

4

Pull the cables through the openings of the base at least 7" to facilitate the wiring job.

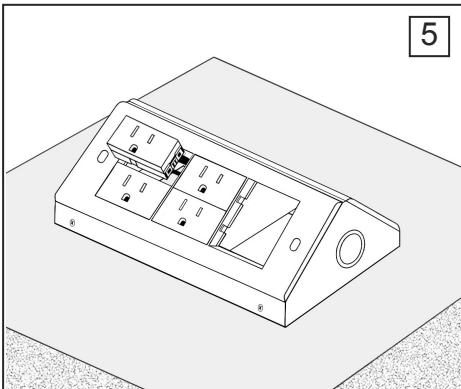

5

Wire devices in accordance with the NEC. Align the modules and push them gently into the opening until they snap in place.

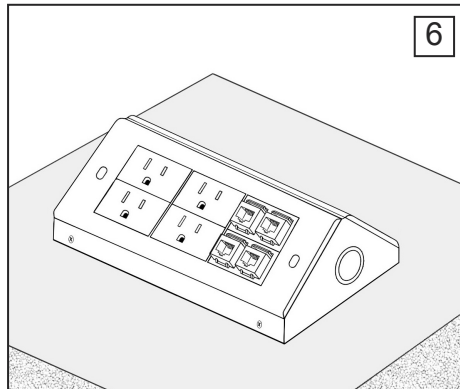

6

Device configuration may vary.



**Warning:**

To be installed and/or used in accordance with appropriate electrical codes and regulations.



**Warning:**

To avoid fire, electrical shock and/or electrocution turn power OFF at the circuit breaker before wiring.



**Caution:**

Wire devices in accordance with the NEC. If you are not sure about existing conductor wires, color coding, polarity and circuit feed contact a licensed electrician.

**DISCLAIMER - (Worldwide)**

FBS FLOOR BOX SYSTEMS MAKE NO WARRANTIES OR REPRESENTATIONS, WHATSOEVER, EXPRESS OR IMPLIED, AS TO THE MERCHANTABILITY, FITNESS OR SUITABILITY OF THIS PRODUCT.

Installer/Buyer of this product must verify the suitability or approval of this product for the specific use with the local codes and/or authorities having jurisdiction in the area where the product will be installed.

**Module removal instructions**

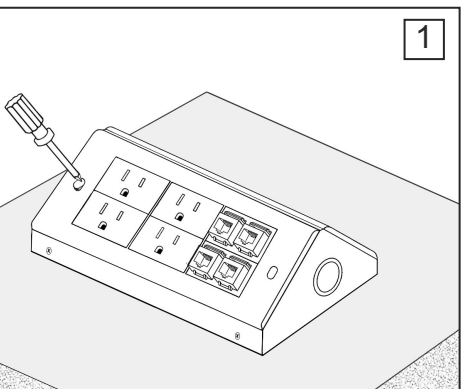

1

Gently press the small screw caps on one side and remove it. Remove the screws to separate the face-plates from body.

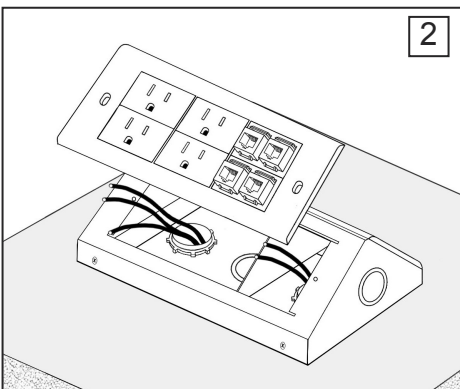

2

Pull out the selected yokes/face-plates and remove the wires from the devices to be removed/replaced.

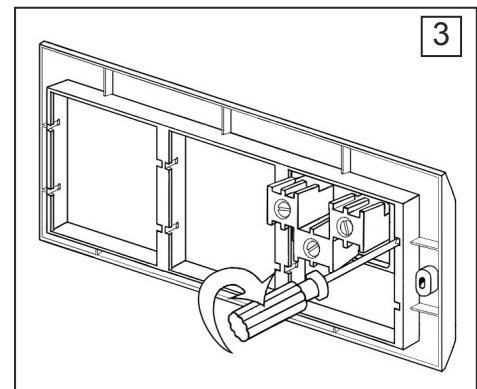

3

Insert a flat head screwdriver (preferably 5 mm width) into the back side of the yoke and turn slightly 10° to 30° until module is released. If needed, repeat on both ends of the module.

**PF10266**  
**Surface Mount Box**  
**-Template-**

CAUTION: When printing copies of this template please be sure template is scaled correctly and is the correct size once it is printed.

