

IMPORTANT: Please read carefully the following instructions before beginning.

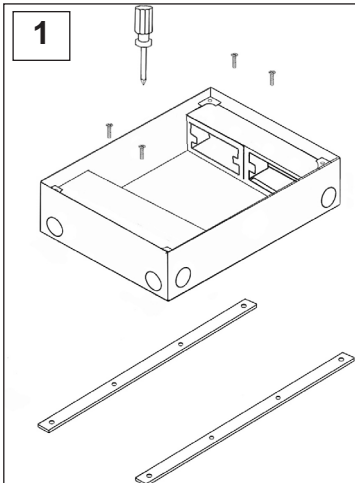

Determine box location and position in accordance to floor plans.

OLD WORK

Unscrew the four screws at the bottom of the box to remove leveling feet.

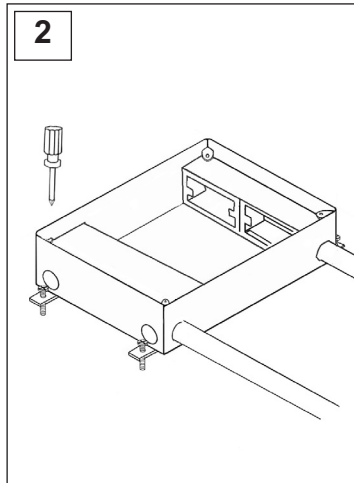

Attach conduits to the selected knockouts. Install temporary cover to prevent debris from entering the box during concrete pour. Duct tape any cracks or seams where concrete may enter.

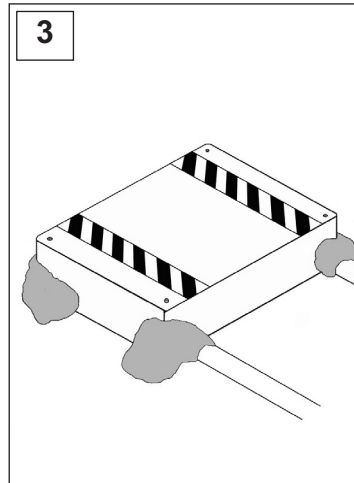

Adjust the leveling screws until the desired level is met. Fix and secure the box to the floor using concrete mix. Add concrete mixture below and around box (if necessary) to level the box in accordance to the final floor level desired.

DISCLAIMER - (Worldwide)
 FBS FLOOR BOX SYSTEMS
 MAKE NO WARRANTIES OR REPRESENTATIONS, WHATSOEVER, EXPRESS OR IMPLIED, AS TO THE MERCHANTABILITY, FITNESS OR SUITABILITY OF THIS PRODUCT.

Installer must verify the suitability or approval of this product for the specific use with the local codes and/or authorities having jurisdiction in the area where the product will be installed.

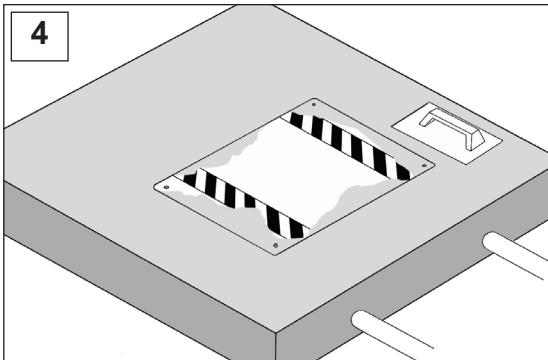

Hand toweling near box edges is suggested once concrete has been poured.

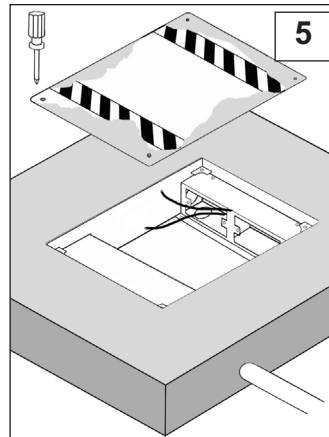

Once Concrete has cured, remove temporary cover. Locate and pull wires.



Warning:

To be installed and/or used in accordance with appropriate electrical codes and regulations.



Warning:

To avoid fire, electrical shock and/or electrocution turn power OFF at the circuit breaker before wiring.

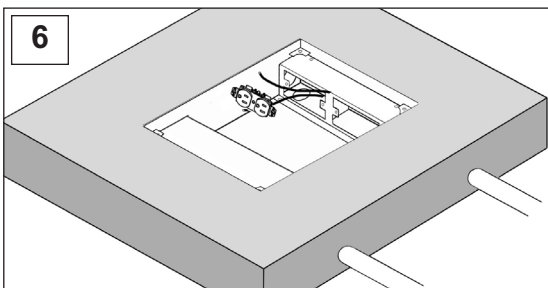

Install barriers, pull cables thru the panel openings and wire devices in accordance with the NEC.

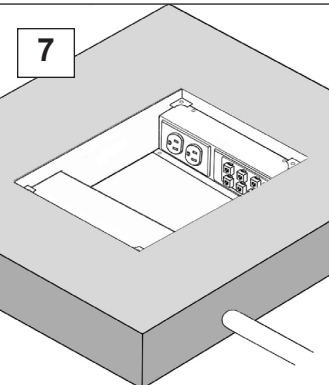

Attach faceplates to devices and mounting panels. Use plate #11601 for receptacles, #11612 Decorator (GFCI) for power or low voltage.



Caution:

Wire devices in accordance with the NEC. If you are not sure about existing conductor wires, color coding, polarity and circuit feed contact a licensed electrician.



8

Install the desired floor covering material (terrazzo, tile, limestone, carpet, etc) on the top of the lid -if applicable- Recessed area: 7/16" (12 mm)

9

Before installing the cover, apply a generous amount of silicone caulk around the opening of the floor box (where the flange sits). Verify that all the perimeter has been properly sealed.

10

Secure the cover to the box using the four supplied screws. Installation complete.

Leveling the floor box

CORRECT

Tile or Carpet

When a floor covering thickness is known in advance (tile, wood, carpet), estimating level to obtain a floor covering flushed with floor box is suggested (as shown on the figure above.); however it is not completely necessary

Tile or Carpet

When concrete is over poured, the cover can still be applied. Need longer screws (supplied by others)

Non beveled Cover Installation

1) Depending on the thickness of the floor covering material, level the box as necessary to obtain a flush finish between the cover and the final floor level as shown on the illustration.

2) Before installing the cover, apply a generous amount of silicone caulk around the opening of the floor box to prevent water from entering the box. Verify that all the perimeter has been properly sealed.

3) Secure the cover to the box using the four supplied screws.

When concrete is flushed with box, the cover can be applied. Need longer screws (supplied by others)

*****INCORRECT*****

Avoid this situation

